

WIGGINS & BOLLE DIAGRAM FOR PROCLAMATION PURPOSES

SIDES Metres		ANGLES OF DIRECTION	Y	CO-ORDINATES System W619		X	S.G. No.
		Constant:		+60 000, 00	+3 570 000, 00		493/2006
AB	156, 39	196 57 50	A	+4 273, 27	+9 138, 67		Approved <i>[Signature]</i> for Surveyor General 2006.02.24
BC	218, 34	345 34 00	B	+4 227, 64	+8 989, 08		
CD	183, 33	344 45 20	C	+4 173, 23	+9 200, 53		
DE	223, 04	20 54 30	D	+4 125, 02	+9 377, 41		
EF	82, 37	99 53 20	E	+4 204, 62	+9 585, 77		
FA	433, 13	181 39 10	F	+4 285, 77	+9 571, 62		
<u>Connections</u>							
Ax	13, 90	90 00 00	x	+4 287, 17	+9 138, 67		
Fy	41, 93	99 53 20	y	+4 327, 08	+9 564, 42		
3218 - 11 Elandsberg			Δ	+1 644, 60	+8 556, 86		
3218 - 43 Rondeberg			Δ	-1 796, 35	+16 245, 90		

Beacon descriptions

- A E - 20mm round iron peg
- B D F - 15mm round iron peg
- C - mid top wooden fencepost
- x y - not beaced

Portion 12 of the Farm Verloren Vlei No.8



Atlantic Ocean

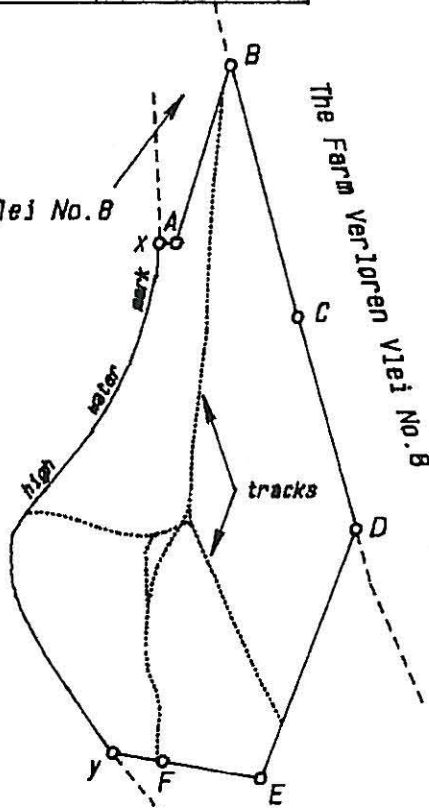

SCALE 1: 6000

The figure A B C D E y high water mark x represents 9,0439 Hectares

Portion 12 of the Farm Verloren Vlei No.8

of land, being

[Handwritten initials]

A PROVINCIAL HERITAGE SITE
OVER PORTION 12 OF THE FARM VERLOREN VLEI No. 8

situate in the Cederberg Municipality

Administrative District of Piketberg

Province of the Western Cape

Surveyed in December 2005 to January 2006

by me

[Signature]
A.H.J. Bolle PLS 0059 Professional Land Surveyor

This diagram is annexed to No. dated i.f.o.

The original diagram is No. 6318/1992 annexed to Transfer/Grant

File No. Pkgb 8
S.R. No. E193/2006
Comp. CH-3BC (4480)

No.1992. .71717

Registrar of Deeds

EXEMPT FROM PROVISIONS OF ACT 70 OF 1970 SECTION 2(b)

EXEMPT FROM PROVISIONS OF CHAPTER III OF ORD. 15/1985

SIDES Metres		ANGLES OF DIRECTION	Y	CO-ORDINATES System W619		X	S.G. No.
		Constant:		+60 000, 00	+3 570 000, 00		493/2006
AB	156, 39	196 57 50	A	+4 273, 27	+9 138, 67		Approved
BC	218, 34	345 34 00	B	+4 227, 64	+8 989, 08		<i>Wiggins</i>
CD	183, 33	344 45 20	C	+4 173, 23	+9 200, 53		for Surveyor General
DE	223, 04	20 54 30	D	+4 125, 02	+9 377, 41		2006.02.24
EF	82, 37	99 53 20	E	+4 204, 62	+9 585, 77		
FA	433, 13	181 39 10	F	+4 285, 77	+9 571, 62		
<u>Connections</u>							
Ax	13, 90	90 00 00	x	+4 287, 17	+9 138, 67		
Fy	41, 93	99 53 20	y	+4 327, 08	+9 564, 42		
3218 - 11 Elandsberg			Δ	+1 644, 60	+8 556, 86		
3218 - 43 Rondeberg			Δ	-1 796, 35	+16 245, 90		

Beacon descriptions

- A E - 20mm round iron peg
- B D F - 15mm round iron peg
- C - mid top wooden fencepost
- x y - not beacons

Portion 12 of the Farm Verloren Vlei No. 8



Atlantic Ocean

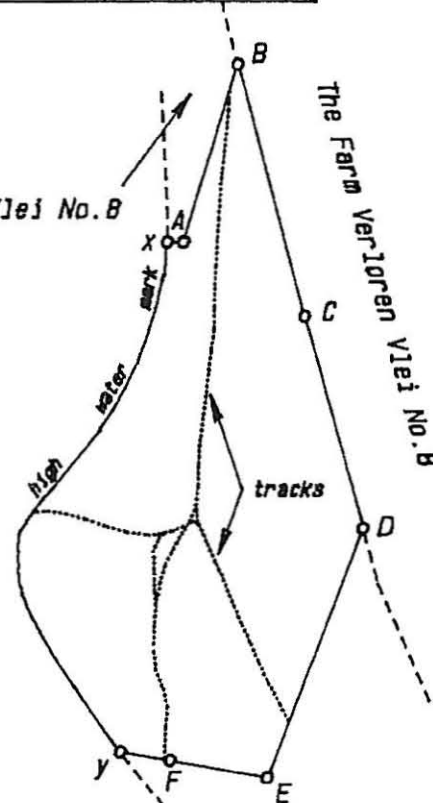

SCALE 1: 6000

The figure A B C D E y high water mark x represents 9,0439 Hectares

Portion 12 of the Farm Verloren Vlei No. 8

of land, being

AW

A PROVINCIAL HERITAGE SITE
OVER PORTION 12 OF THE FARM VERLOREN VLEI No. 8

situate in the Cederberg Municipality
Administrative District of Piketberg
Surveyed in December 2005 to January 2006

Province of the Western Cape

by me

A.H.J. Bolle
A.H.J. Bolle PLS 0059 Professional Land Surveyor

This diagram is annexed to
No.
dated
i.f.o.

The original diagram is
No. 6318/1992
annexed to Transfer/Grant

File No. Pkgb 8
S.R. No. E193/2006
Comp. CH-3BC (4480)

No.1992. .71717

Registrar of Deeds

EXEMPT FROM PROVISIONS OF ACT
70 OF 1970
SECTION 2(A)

EXEMPT FROM PROVISIONS
OF CHAPTER III
OF ORD. 15/1985

WIGGINS & BOLLE

SIDES Metres		ANGLES OF DIRECTION	Y	CO-ORDINATES System WGI9		X	S.G. No.
		Constant:		+60 000,00	+3 570 000,00		Approved for Surveyor General
AB	156,39	196 57 50	A	+4 273,27	+9 138,67		
BC	218,34	345 34 00	B	+4 227,64	+8 989,08		
CD	183,33	344 45 20	C	+4 173,23	+9 200,53		
DE	223,04	20 54 30	D	+4 125,02	+9 377,41		
EF	82,37	99 53 20	E	+4 204,62	+9 585,77		
FA	433,13	181 39 10	F	+4 285,77	+9 571,62		
Connections							
Ax	13,90	90 00 00	x	+4 287,17	+9 138,67		
Fy	41,93	99 53 20	y	+4 327,08	+9 564,42		
3218 - 11 Elandsberg			Δ	+1 644,60	+8 556,86		
3218 - 43 Rondeberg			Δ	-1 796,35	+16 245,90		

Beacon descriptions

- A E - 20mm round iron peg
- B D F - 15mm round iron peg
- C - mid top wooden fencepost
- x y - not beacons

Portion 12 of the Farm Verloren Vlei No.8



Atlantic Ocean

SCALE 1: 6000

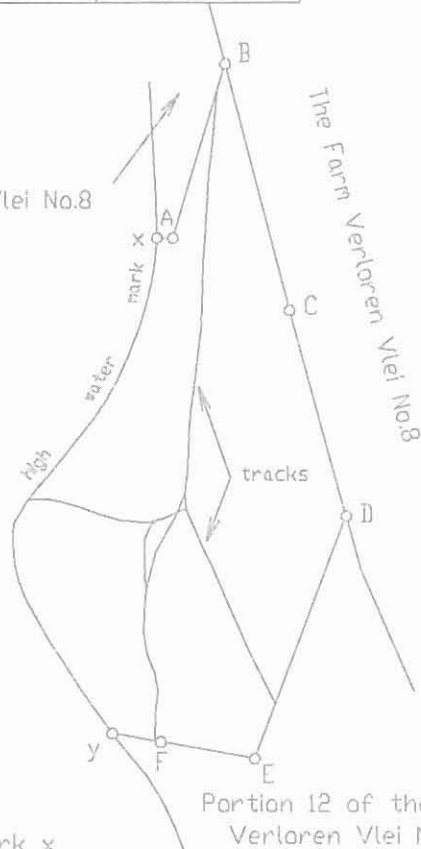

The figure A B C D E y high water mark x represents 9,0439 Hectares

of land, being

A PROVINCIAL HERITAGE SITE
OVER PORTION 12 OF THE FARM VERLOREN VLEI No. 8

situate in the Cederberg Municipality

Administrative District of Piketberg

Province of the Western Cape

Surveyed in December 2005 to January 2006

by me

A.H.J. Bolle PLS 0059 Professional Land Surveyor

This diagram is annexed to
No.
dated
i.f.a.

The original diagram is
No. 6318/1992
annexed to Transfer/Grant
No.1992. .71717

File No.
S.R. No.
Comp. CH-3BC (4480)

Registrar of Deeds

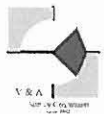
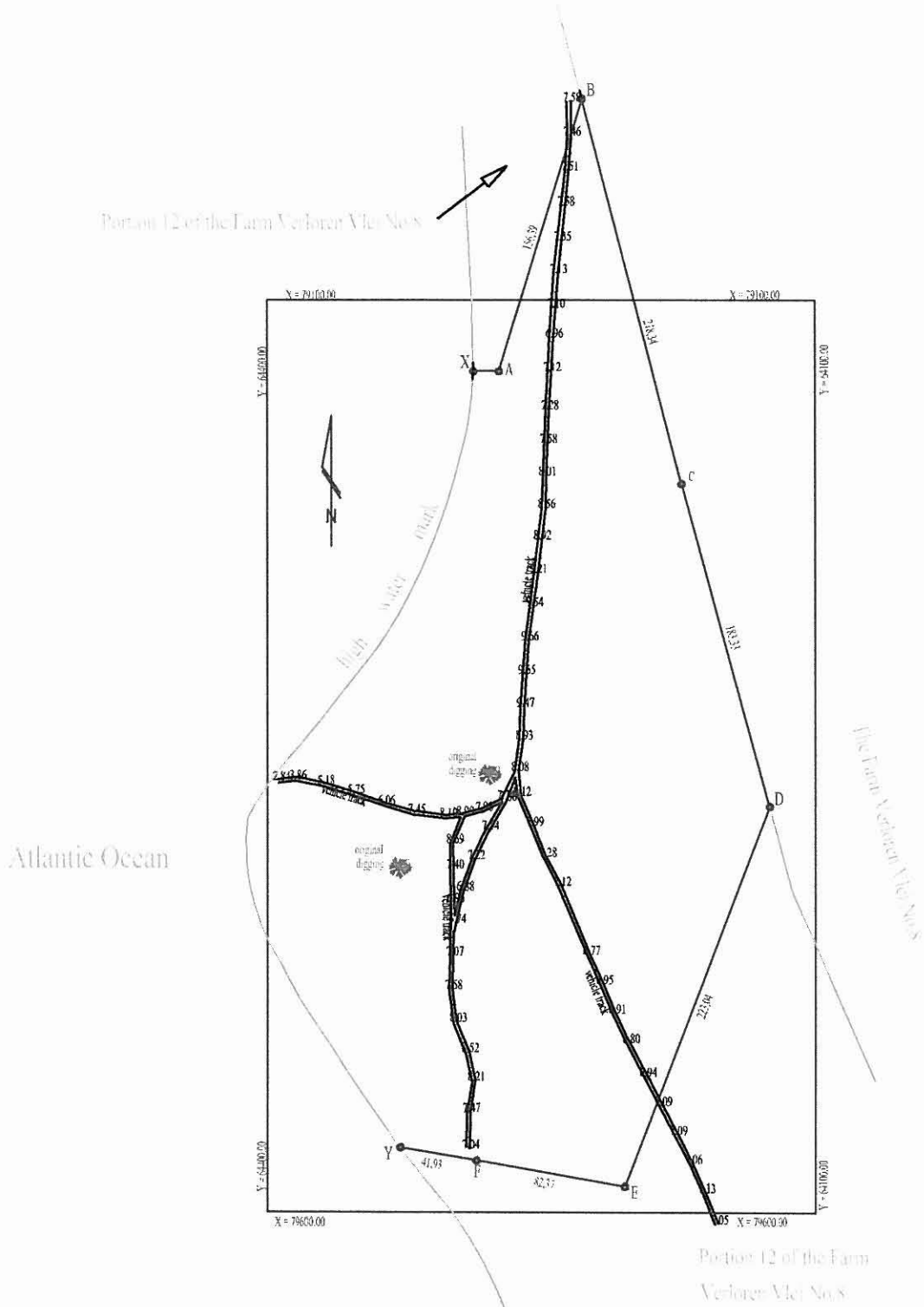

**SITE SURVEY OVER PORTION
12 OF THE FARM VERLOREN
VLEI No.8 ELANDSBAAI**

CO-ORDINATE SYSTEM : WGS
 DATUM : Approximate M.S.L.
 DRAWING No. : VA555/06
 DATE : Dec.2005 & Feb.2006
 ELECTRONIC FILE : "ELAND2"
 SURVEY BY : Anton Bolle & Tony Vroom

BENCHMARKS:

REMARKS:

VROOM & ASSOCIATES
 SURVEY CONSULTANTS
 since 1982
 CAPE TOWN SOUTH AFRICA
 PO Box 23443 Claremont 7735
 Tel:021 7612287 Fax:021 7970685
 email: vroom@iafrica.com
 ASSOCIATE: ANTON BOLLE

SCALE:
 REVISION

This drawing is copyright and remains the property of Vroom & Associates.